

SAN MARINO

ESTATE HOMES

The Alessandro

Elevation Forthcoming

±3,530 LSF | 4 BEDROOM | STUDY | 3.5 BATH | 3 CAR GARAGE

www.SanMarinoFL.com

Model Home: (321) 241-4938 | Development Office: (321) 751-6850

Floor plans and elevations are artist's concepts and may vary in precise detail from the plans and specifications.
San Marino Estate Homes reserves the right to change prices, plans, features, dimensions and specifications without notice. Elevations and floor plans are subject to Homeowner Association (HOA) restrictions. Subject to errors, omissions, deletions and availability. CRC 1331383



Living Area	±3,530
Front Entry	48
Rear Porch	521
Garage	755
Total	±4,854

±3,530 LSF | 4 BEDROOM | STUDY | 3.5 BATH | 3 CAR GARAGE

Floor plans and elevations are artist's concepts and may vary in precise detail from the plans and specifications. San Marino Estate Homes reserves the right to change prices, plans, features, dimensions and specifications without notice. Elevations and floor plans are subject to Homeowner Association (HOA) restrictions. Subject to errors, omissions, deletions and availability. CRC 1331383

Optional Baths:

Bath 2 (Opt. B)

Opt. Private Bath 3 (A or B) (I.L.O. Bath 3)

Opt. 4th Bath (A or B) (I.L.O. Storage)

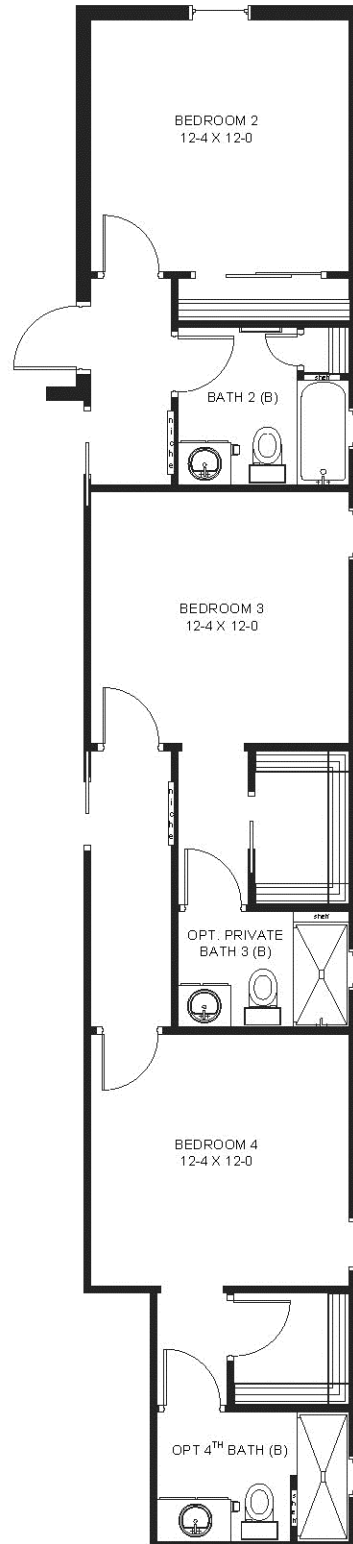
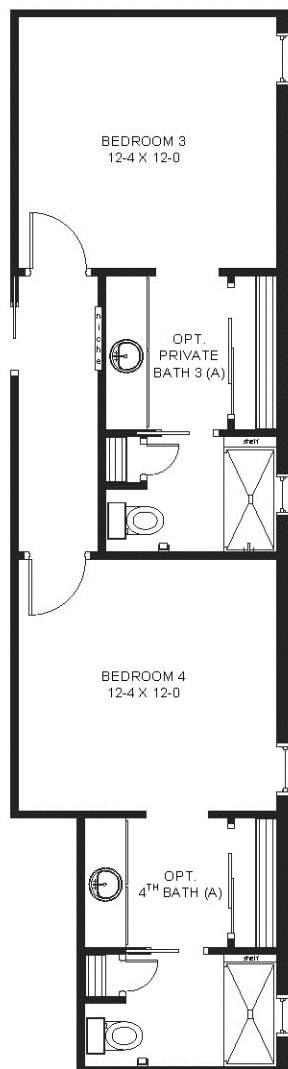

Floor plans and elevations are artist's concepts and may vary in precise detail from the plans and specifications. San Marino Estate Homes reserves the right to change prices, plans, features, dimensions and specifications without notice. Elevations and floor plans are subject to Homeowner Association (HOA) restrictions. Subject to errors, omissions, deletions and availability. CRC 1331383